

Cordoba Engineering Private Limited

An IATF – 16949; ISO 14001; ISO 9001; ISO 45001;
ZED; UDYAM; GST & IEC Certified Company

CORDOBA ENGINEERING PRIVATE LIMITED



MD's DESK

1. On the blink of realizing a long cherished ambition since our journey from 1975 till date, it has been wonderful and we have reached new heights.
2. Conquering obstacles & imponderable with remarkable equanimity of mind & of translating dreams into reality. CEPL offers the highest quality at a reasonable price to meet our customers expectation.
3. With uncanny business acumen with a philanthropic zeal, Mr. Amit Garg & Mr. Sumit Garg have joined hands with me and now we are taking our business to new horizons, with diversified business lines i.e. from the manufacturing of sheet metal components to heavy fabrication & material handling designs & equipments.
4. Behind the success of CEPL is the saga of teamwork. We would like to acknowledge the role played by our executive, staff and other members of the CORDOBA ENGINEERING PVT. LTD (CEPL) family.
5. In the new millennium, we stand committed to innovation, to change, to achiving breakouts to move forward in the new century, while retaining the values that have been like a beach in his journey so far. Lastly I would conclude by "And while the law of competition may be sometimes hard for the individual, it is best for therace because it ensures the survival of the fittest in every department“.



HIGHLIGHTS

1. The company was incepted in 1975 at Adityapur Industrial Area, Jamshedpur.
2. The company is an IATF – 16949; ISO 14001; ISO 9001; ISO 45001; ZED; UDYAM; GST & IEC Certified Company.
3. The company has been financial rated by Duns and Brad Street (Duns No:'676283369').
4. The company is registered with GSTIN (20AABCC0348K1Z5) by Govt. of India.
5. The company is certified under Pollution Control Board, Govt. Of India.
6. Installed capacity 12000 MT P.A which will gradually enhance to 24000MT P.A.
7. Uninterrupted Power Supply of 220 KVA.



PLANT LAYOUT

PLANT INFRASTRUCTURE

COVERED AREA - 1,25,000SQ FT.

UNCOVERED AREA -12,500SQ.FT.

UNUTILIZED - 37,500SQ.FT.

PRESENT WORKFORCE 180 NOS

SKILLED - 120 NOS.

SEMISKILLED - 20 NOS.

UNSKILLED - 20 NOS.

STAFF - 20 NOS.

SHOP FLOOR LAYOUT, HOUSE KEEPING & MATERIAL HANDLING

Shop floor layout is planned in such a way to frequent movement of product from one machine to another one during production process. We are giving priority to clean the house properly every day to maintain atmosphere and good look. They are trained with examples the consequences of the lack of house keeping. In the case material handling, we are using electric hoist & manual trolley.

PLANT LAYOUT - 1

CORDOBA ENGINEERING PRIVATE LIMITED

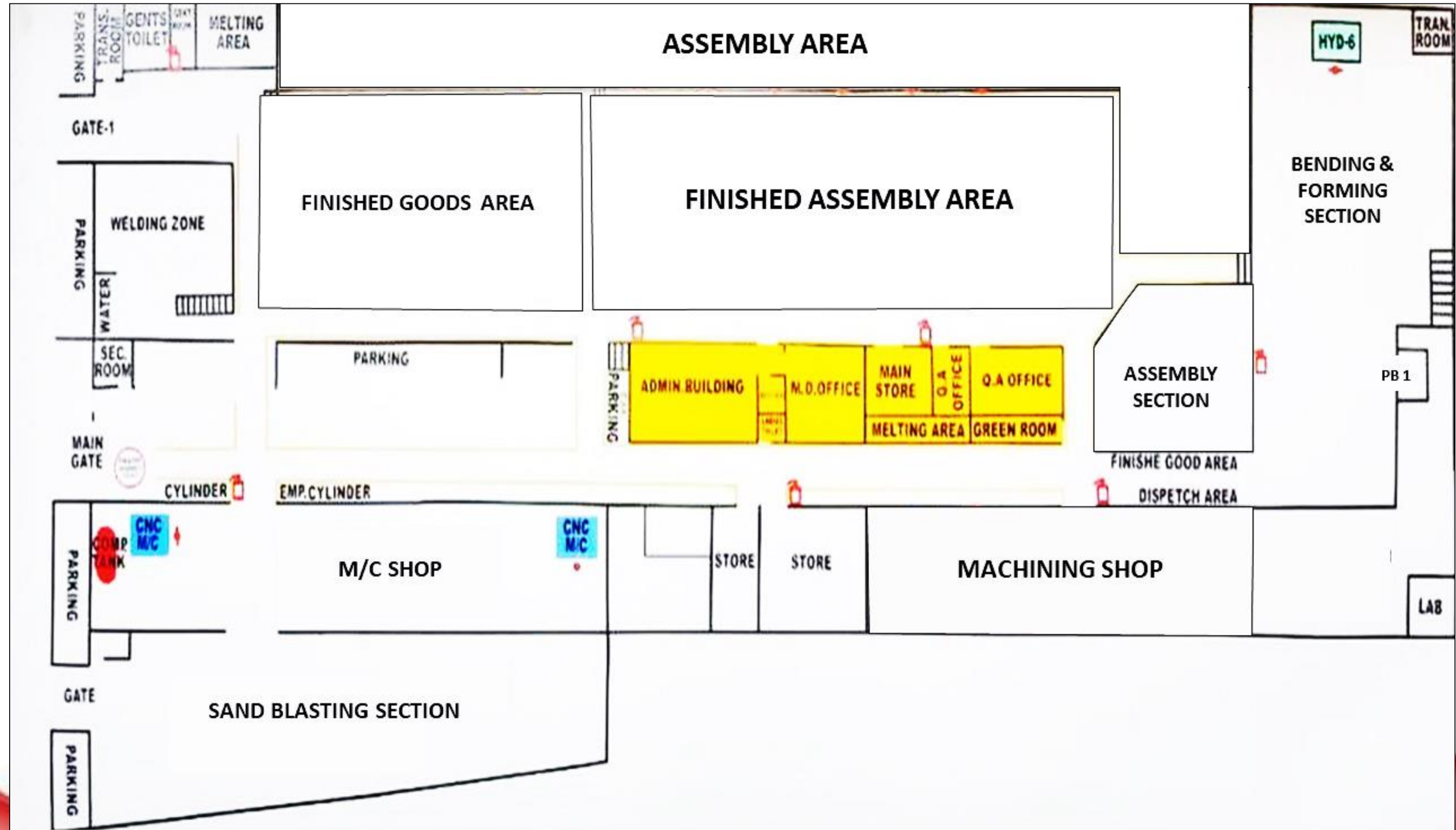

PLANT LAYOUT - 2

GAJANAN ENGINEERING PRIVATE LIMITED

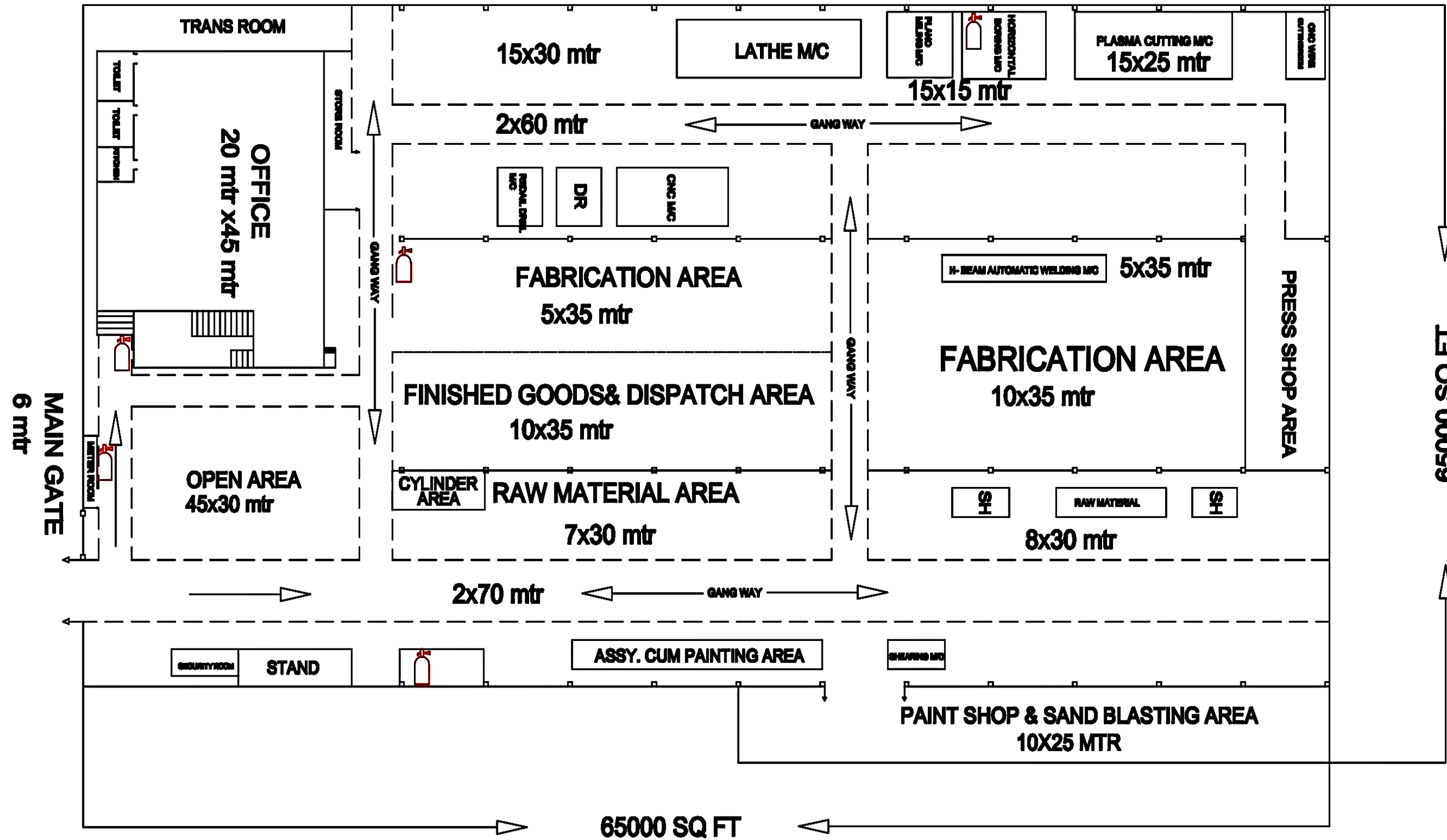

BAY-1



BAY-2



BAY-3



Cutting & Bending Solutions

We have 6 Nos. of shearing machines having shearing capacity upto 16mm Thickness/ Bed Size and individual Capacity of the machines are as follows:

CNC Shearing Machine make – Hindustan Hydraulics – i) S.S Material 0.5 - 4mm ii) M.S Material 0.5- 8mm

CNC Bending Press Brake – Upto 4.5mtr &
Hydraulic Press (With Cushion) 3Mtrx1.5Mtr Bed Size 1000 Ton

With CNC Plasma and Oxy Cutting

Bed Size-4.5 Mtr x18 Mtr
Capacity PLASMA

i) S.S Material 3-12mm
ii) M.S Material 3-16mm

Capacity Oxy-Cut

i) 3-300mm Thick Slab



New Development Facilities & Rolling Facility

[4] NIBBLING MACHINE : (ONLY FOR DEVELOPMENT ITEM)

Having the capacity of 2.5 mm - 1 No.



[5] TURRET MACHINE FOR HEAT SHIELD

Make : Amada Pega 357 No. of stations : 44 No. of auto indexes : 2 Controller : Fanuc Punching Force : 30 Tons Metalix-Single User CAD/CAM with True Shape Automatic Nesting



[6] ROLLING MACHINE

Make : GM Icon

Capacity : 40 Mm Thick And 2.5 M Width



Welding Solutions

Welding Machines:

The machines are calibrated periodically, welder's are also trained time to time. Supervisors inspecting the welding Quality in all the products.

- 48 Nos. of Mig Welding Machines,
- 5 Nos. of Arc Welding Machines
- 3 TIG Machine
- 2 Sub Merged
- 5 PUG Cutting
- 8 Spot Welding (Integral & Stationery) - Supporting the Fabrication.
- SAW
- Stud Welding Machine
- Automatic Beam Welding Machine



Air Compressor & Electric Hoist

Air Compressor

Compressorsystem, which fulfils the demand of Air Pressure. In addition 8 Nos. of Air Compressor are kept as reserve to meet with requirement.

- Atlas Copco 130 cfm
- Equipment's 70 cfm & 44.1 cfm
- Screw Compressor



Electric Hoist:

- Electric Hoist 5 Ton
- Electric Hoist 15 Ton
- Electric Hoist 10 Ton
- Electric Hoist 40 Ton
- Electric Hoist 20 Ton
- Electric Hoist 3 Ton



Laboratory Facilities

Hardness Testing Machine HRC Toe Load Testing Machine, Microstructure Equipment's Muffle Furnace (0 To 1100 Deg. Temp) Carbon Apparatus (% Of Carbon Testing), Weight Balancer, Hydro Testing. Rest Other Testing – Mechanical/Chemical Is Outsourced To NABL Certified Labs With Annual Agreement.



**Annual Contract of Mechanical
and Chemical Testing with:**

**Adityapur Auto Cluster
&
ASR Metallurgy Private Limited**



Painting Solutions

Painting Is A Special Process , Which Required Special Attention For Which We Have A Team Of Peoples Who Look After Day To Day Production. There Are Three Primary Coating Technologies Powder Coating, Electro Coating And Liquid Painting (Spray Painting). Powder Coating And Electro Coating Offer The Qualities Of Excellent Performance And Durability. In This Millennium Of Competition, Faster Production & Lower Rejection Rate Without Compromising Quality Is The Essence Of Any Successful Industry. To Achieve Speed And Accuracy With Superior Quality, Human Errors Have To Be Minimized.

1. **Pre-Treatment (Pickling/Sand Blasting)**
2. **Spray Painting**
3. **Powder Coating**



Designing

Quality of design of a product is concerned with the stringency of the specification for the manufactures of the product. Generally greater the requirement for the strength, fatigue resistance, life, function and interchange ability of a manufactured item, better the quality of design. Obviously, the design should be simplest and least costly which must meet the customers requirement.

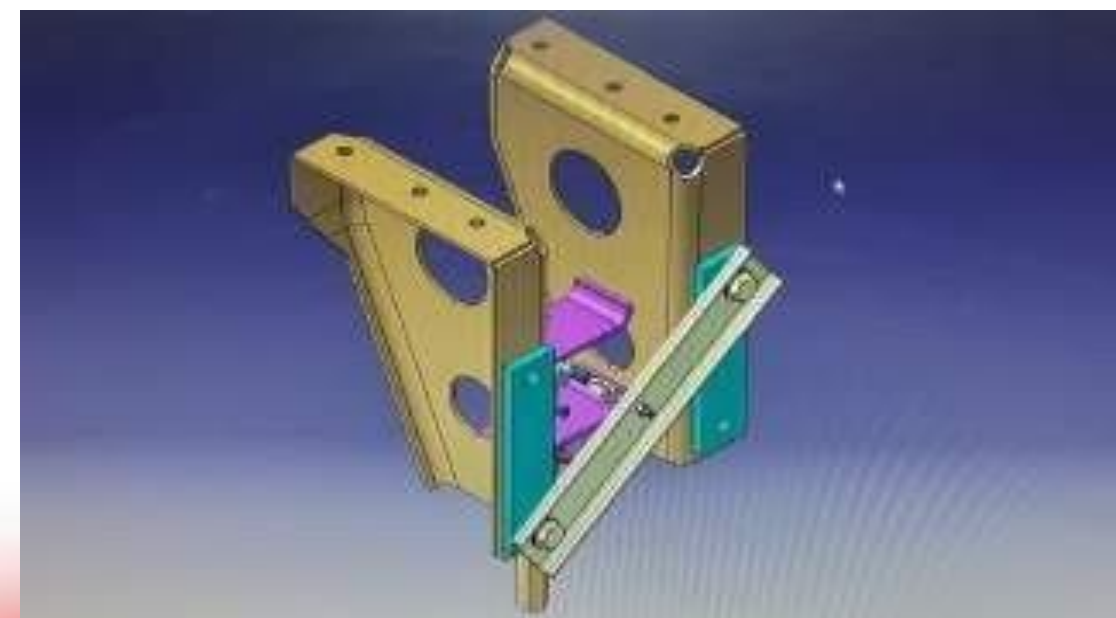
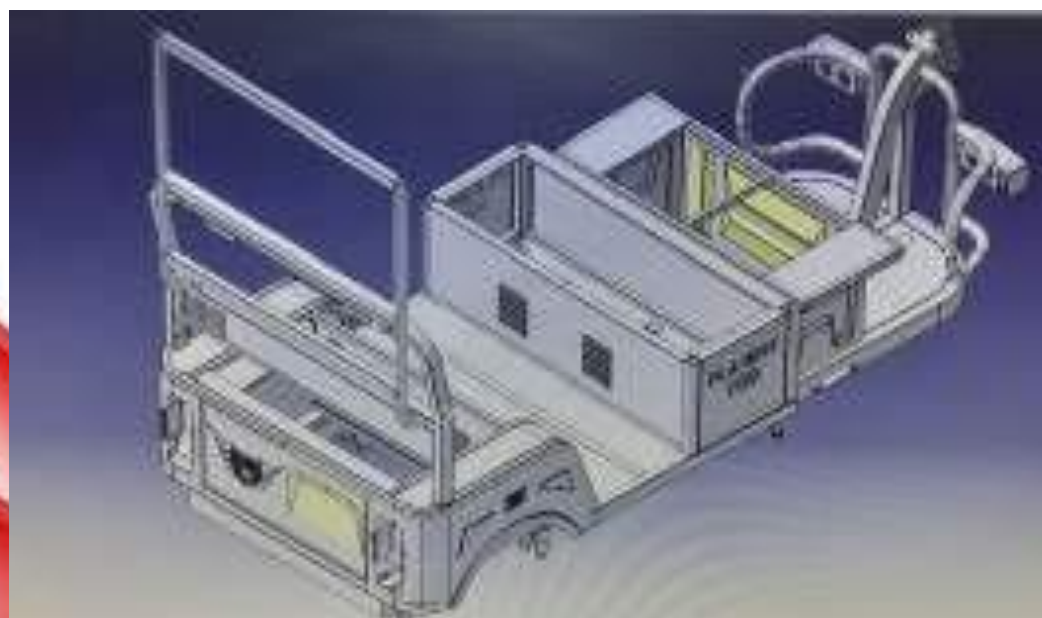
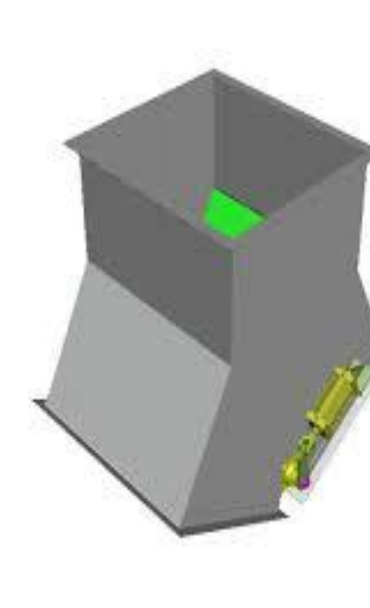
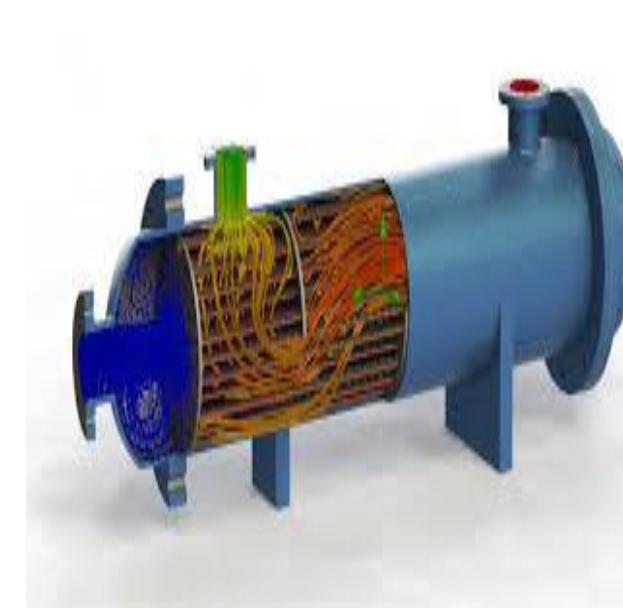
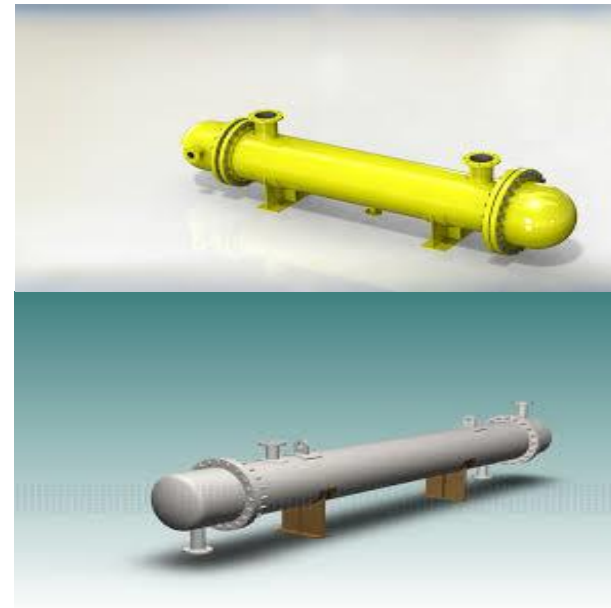
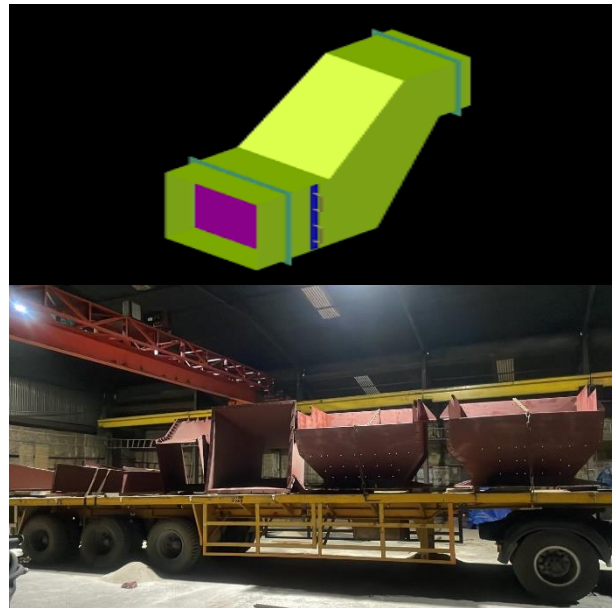



Tool Room & Machining

Tools Are The Main Critical Component At The Production Stage Of Pressed Components, For Which We Have A Well Maintained Tool Room For Our Production Needs. We Own Advanced Product Design System, Advanced Process Facilities, Perfect Test Method And Complete Dies Processing Equipment's. Our Dies Are Designed And Produced Perfectly In House.

Tool Room Equipped With All Necessary Machineries & Tools. Details Are As Follows:

- Planner Machine 2 Mtr.
- Milling Machine Universal
- Surface Grinder 1x3" .
- Radial Drill 40mm Dia.3 Nos.
- Shaper Machine 30' 3
- Lathe Machine 8' (max) .
- Bench Grinder 8'
- Lathe Machine 9'
- Drill Machine 31mm Dia
- Surface Plate 4x4"
- Portable Grinder, Sander & Hand Drill
- Surface Grinding Machine 12x24"
- CNC Milling M/C BFW Make UF30/CNC45
- CNC Milling M/C BFW Make VMC-T20
- Hyd. Surface Grinding Machine 12x24"
- Mill & Drill M/C
- Hand Pallets 500 Kgs.
- Die Loader 1000 Kgs.

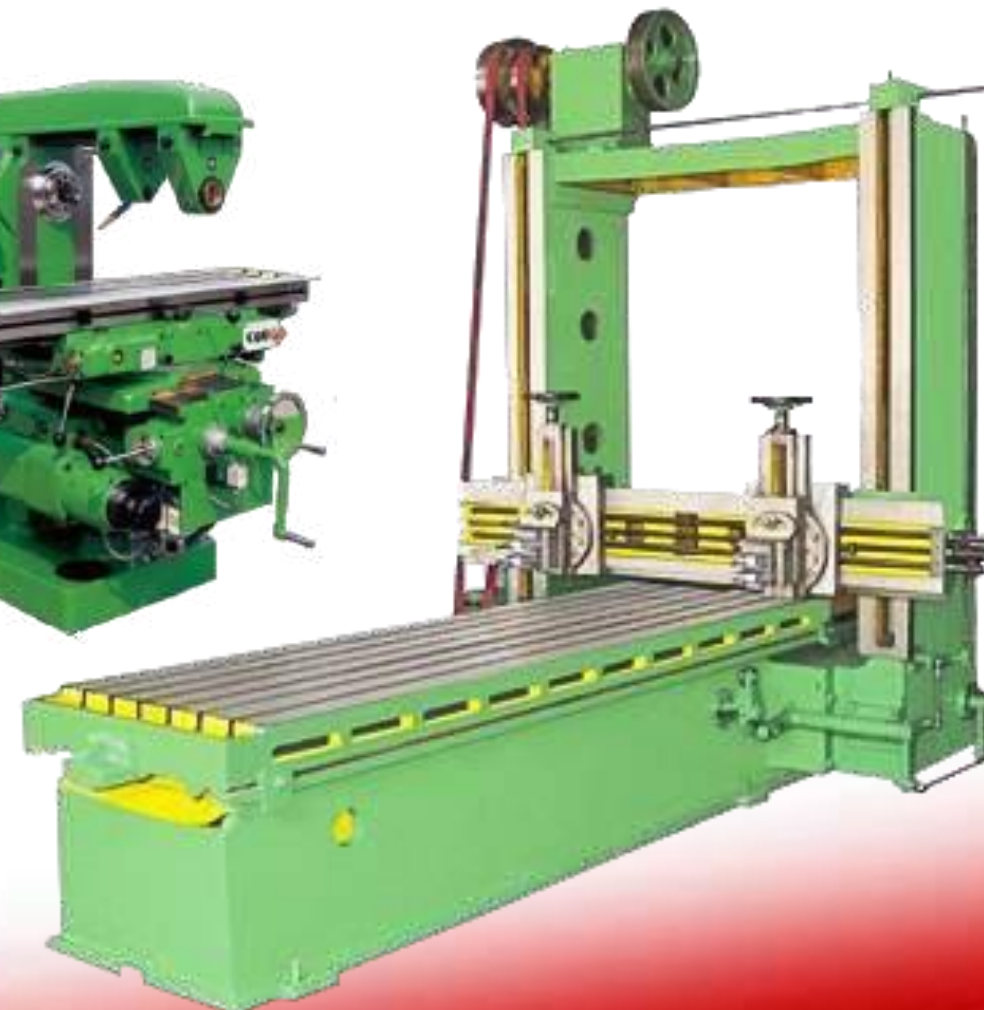

Heavy & Assembled Job Machining

[1] Richard Horizontal Boring

Machines are running in good conditions. Time to time over hauling of machines, lubricating the machine and giving the load within the tolerance returns good performance of machines. Supervisors and operators giving their utmost attention they keep the machines as well as the tooling & equipment in good conditions and every Saturday 4.00 PM to 4.30 PM an audit is conducted.



Specification:-
Bed Size - 1800x1200mm S
pindle Ø100mm

[2] Plano Milling



Specification:-
Bed Size - 1500x5000mm
Spindle Ø100mm

[3] 16 ft Lathe



Specification:-
Chuck Ø600mm
Length – 3000mm

Products – 2023-24



L&T Rourkela - Adjusting Cap



LCP On Site Assembly Condition After Supply



Lump Gate Assembly - TSLP



Operating Lever



Shell For Rolling - 28mm X 1mtr X 12mtr - In DRA Unit - TSLP



Shuttle Conveyor



SRU Burner Packed Condition



T S Gamharia - Ring Of D I Unit

(India Oil)

Quality Assurance

- To Achieve Zero Defects By Continuous Improvement In Process To Produce Quality Jobs From The Beginning Itself.
- To Produce Quality Components By Consistent Adherence Of Quality Systems.
- To Sell Only Quality Components To Our Valued Customers At Competitive Prices.
- To Achieve Total Quality Management For The Satisfaction Of Our Customers And Enlistment Of Our Work Force.



Our Expertise In Reverse Engineering

Reverse engineering is the process of duplicating an existing component, subassembly, or product without having the original drawings, documentation, or computer models.

Reverse engineering is a common need across a wide variety of industries and technologies. We have used reverse engineering to provide a wide variety of services to companies in the manufacturing -steel sector, cement industry, power sector and Oil & Gas sector. Using our best-in-class engineer, experience technicians, software and equipment, we have been able to capture data from parts to entire manufacturing facilities.

Reverse engineering is useful in situations where you need to:

- Identify an assembly's part in equipment/facility and their interrelationships.
- Build new part of the existing assembly/facility/equipment.
- Rebuild/Refurbish an assembly/facility/equipment and draft new drawings for future replacements.
- Scan the facility/equipment and plan changes in the layout to improve performancesuch as improving where a product is experiencing excessive wear.
- The original manufacturer of a part/assembly/equipment/facility no longer makes it or no longer exists or unwilling to provide replacement parts, and a customer needs to replace a part.
- To update obsolete materials or antiquated manufacturing processes.

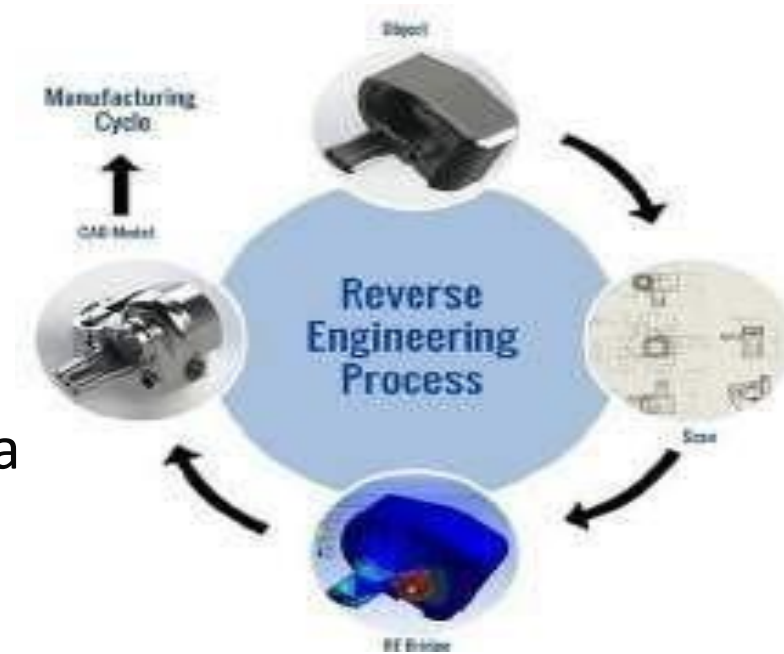

Our Expertise In Reverse Engineering

- To reverse engineer a part/assembly/equipment/facility, you reverse that process. You start with a finished part, scan it to build CAD model/drawings, and then refine those drawings. Step 1: Capture Data, Step 2: Refine the Model AND Step 3: Manufacturing
- Our team at Cordoba Engineering Pvt Ltd has all of the equipment, expertise, software, and trained experts that any client need for their reverse engineering projects. From small parts to full facilities, we have you covered.
- We strive to be your one-stop shop for Process equipment and Projects big and small.
- We can work with all metals (Ferrous and Non Ferrous), stainless steels, and alloys to build your products to your requirements with the best-in-class machines to ensure quality and workmanship.
- Our expertise includes components like All types of Vessels, Exchangers, Coolers, Tube bundles, Zinc Pot, Titanium Tray, Stone box, Temperature Probe, Snout horn, Water turf cover, Tart cooling tunnel etc

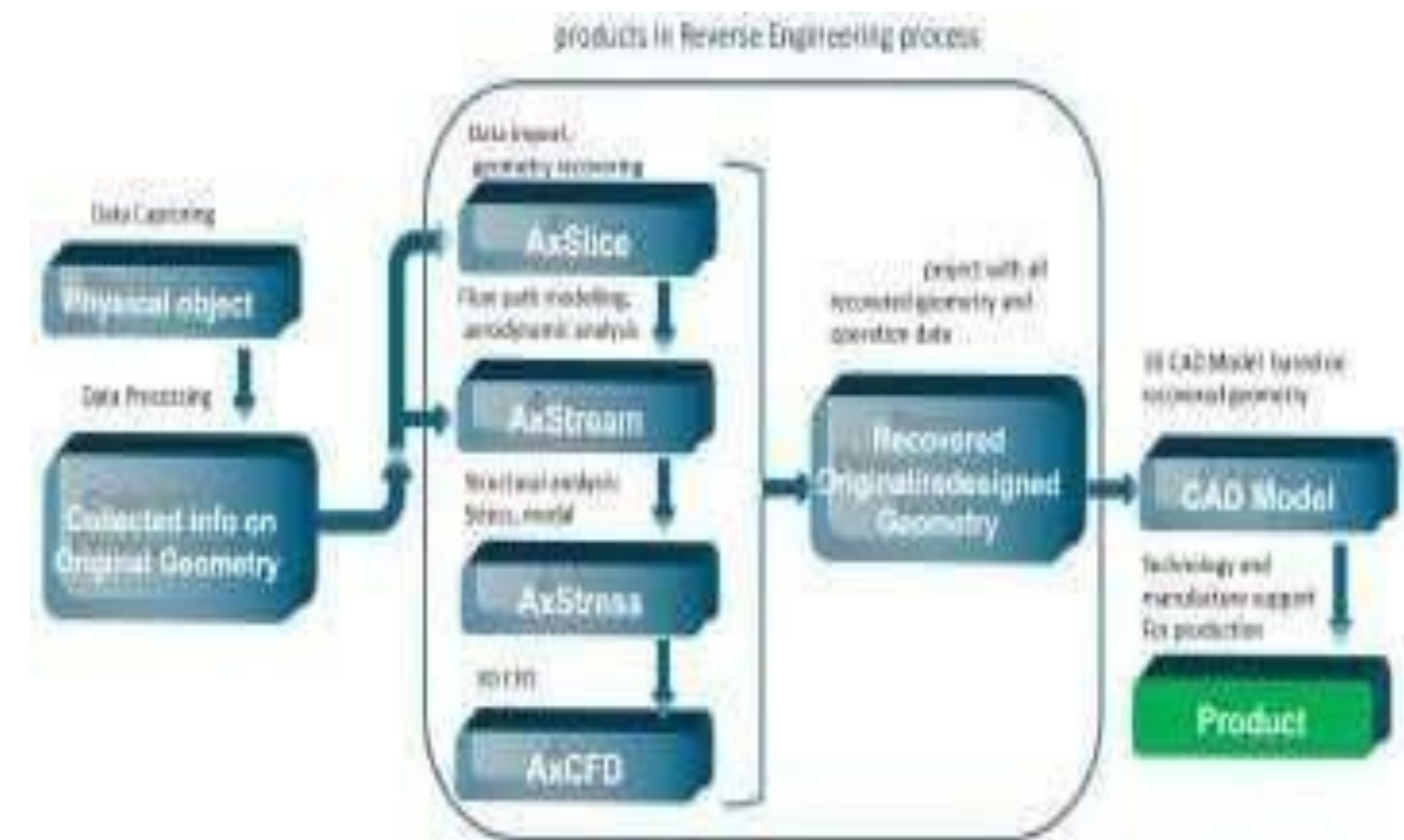

Our Esteemed Customers



Business Expansion Plan

- Land Acquisitions: 5 acre land in industrial area of Adityapur and we are also expanding our unit i.e. for development of Railways sub assembly parts for Cabin/Engine/Boogie related orders. Further we have a unit for Fabrication, and space to accommodate new machineries/project and a well settled Value added Engineering section and Reverse Engineering Team.
- Our Investment plan for this year include purchase of Plano Miller, Stud Welding, EOT Cranes, SAW Machine, H Beam Automatic Welding Facility, Material Handling Equipment's, and Inspection related Instruments for total development of our existing systems.
- Technology: -We are always at a pressure of supplying Prototype components so that you can bring up the new models at a faster pace in order to meet the customers demand. New facilities dedicated for our Prototype components only i.e.CNC Laser Cutting Machine has been initiated.
- Value Engineering: -We are initiating in MAKE IN INDIA projects.
- New Registration: - We have targeted Steel Sector, Cement Industry, Chemical Industry, Power Sector, Oil & Gas Sector and Mining Industries for registration. We have appointed three different team of marketing executives in different cities to explore the scope of customized work in above sectors.

Certificates

QCS MANAGEMENT PVT. LTD.
MANAGEMENT SYSTEMS CERTIFICATION

Certificate of Registration

ISO 14001:2015 (Environment Management System)
CORDOBA ENGINEERING PRIVATE LIMITED

ADDRESS: PHASE 1, NS3, ADITYAPUR INDUSTRIAL AREA, ADITYAPUR, SERAIKELA-KHARSAWAN, JHARKHAND-832109, INDIA

Scope of Certification:
MANUFACTURER AND SUPPLIER OF BLEW METALLIC WELDING EQUIPMENT, PROCESS PLANT EQUIPMENT (PRESSURE VESSEL, HEAT EXCHANGER, TANKS, COLUMNS ETC), FABRICATED COMPONENTS AND STRUCTURE OF STEEL, POWERS, PETRO-CHEMICAL AND MINING INDUSTRIES.

Certificate Number : QCSMPLE/A/0198

Initial Issue Date : 21/09/2021
Current Issue Date : 01/07/2023
Expiration Date : 20/09/2024

Re-certification Due Date : 20/09/2024

GA GLOBAL ACCREDITATION | IR:AO REGISTERED | Poojha Bogchi (Managing Director)

QCS MANAGEMENT PVT. LTD.
REGISTERED OFFICE: ENGLISH BAZAR STREET, ANANDAPUR, SRIKANTHAPUR, JHARKHAND-831006, INDIA
www.qcsindia.com

QCS MANAGEMENT PVT. LTD.
MANAGEMENT SYSTEMS CERTIFICATION

Certificate of Registration

ISO 45001:2018 (Occupational Health & Safety Management System)
CORDOBA ENGINEERING PRIVATE LIMITED

ADDRESS: PHASE 1, NS3, ADITYAPUR INDUSTRIAL AREA, ADITYAPUR, SERAIKELA-KHARSAWAN, JHARKHAND-832109, INDIA

Scope of Certification:
MANUFACTURER OF SHEET METAL, FABRICATED, MACHINED, PHOSPHATED, PAINTED AND POWDER COATED COMPONENTS

Certificate Number: QCSMPLOHS/A/0216

Initial Issue Date : 10/09/2021
Current Issue Date : 06/09/2023
Expiration Date : 09/09/2023

2nd Surveillance Audit Within : 08/07/2023
Re-certification Due Date : 08/08/2024

GA GLOBAL ACCREDITATION | IR:AO REGISTERED | Poojha Bogchi (Managing Director)

QCS MANAGEMENT PVT. LTD.
REGISTERED OFFICE: ENGLISH BAZAR STREET, ANANDAPUR, SRIKANTHAPUR, JHARKHAND-831006, INDIA
www.qcsindia.com

Government of India
Form GST REG-06
(See Rule 19(1))

Registration Certificate

Registration Number: 20AABCC0348K125

1. Legal Name	CORDOBA ENGINEERING PRIVATE LIMITED
2. Trade Name, if any	M/S CORDOBA ENGG. PRIVATE LIMITED
3. Constitution of Business	Private Limited Company
4. Address of Principal Place of Business	Phase 1, NS3, Adityapur Industrial Area, Adityapur, Seraikeela-Kharsawan, Jharkhand, 832109
5. Date of Liability	01/07/2017
6. Period of Validity	From 01/07/2017 To NA
7. Type of Registration	Regular
8. Particulars of Approving Authority	

Signature: _____
Date: _____
Designation: _____
Jurisdictional Office: _____
Date of Issue of Certificate: 26/09/2017

Note: The registration certificate is required to be prominently displayed at all places of business in the State.

For CORDOBA ENGINEERING PVT LTD
Director

Factories Act - 1947

Government of Jharkhand
FACILITY INSPECTION DEPARTMENT
(Department of Labour, Employment, Training & Skill Development)

LICENCE

Application ID: FC/14/18/00017
Licence No: FC/AM/09/0017961

1. Name of the Factory: M/S. CORDOBA ENGINEERING PRIVATE LIMITED
30th December 2019

2. Location of Factory: NS3, PHASE - 1, INDUSTRIAL AREA, ADITYAPUR, DIST - SERAIKELA-KHARSAWAN
Post Office: ADITYAPUR INDUSTRIAL AREA
Block: GANSHAPUR
State: JHARKHAND
Pin Code: 832109

3. Name of Occupier: SATISH KUMAR GARG

4. Type of occupying body: PRIVATE LIMITED COMPANY IN BOARD

5. Maximum number of persons to be employed at any one time: 1,970/0 only

6. Total installed capacity (Not Exceeding):
(a) In Horse Power (HP or that fig): 240 H.P.
(b) In case of Electricity generating, Generating and Transforming Station - D.G.SET: 125 K.W. Transformer: 300 K.W.

INSPECTOR OF FACTORIES
CHARGE - SERAIKELA & KHARSAWAN
Jharkhand-832109

1. This licence will expire on 31st December, 2021.
2. Name of Manufacturing process of the Licensor is SHEET METAL.
3. This is a category 'A' licence and does not require any special conditions.
4. This licence has been granted on the basis of the information given by the applicant and is valid for the purpose of this act only.

JHARKHAND STATE POLLUTION CONTROL BOARD

TOWNSHIP ADMINISTRATION BUILDING, HEC COMPLEX, DHURWA, RANCHI - 834004
Telephone: 0651-2408830 (Fax) 2400851/2400852/2401147/2400979/2400139

Ref No: JSPCB/HORNC/CTO-611/2018/2019/1864 Dated: 20/10/2019

Consent to operate (CTO) under section 25 (2) of the Water (Prevention & Control of Pollution) Act, 1974 and under section 21 of the Air (Prevention & Control of Pollution) Act, 1981

1. Application (A) dated 20/10/19-11 of CORDOBA ENGINEERING PRIVATE LIMITED, Occupier Name SATISH KUMAR GARG for consent under section 25 (1) (a) & 26 of the Water (Prevention & Control of Pollution) Act, 1974 and under section 21 (1) of the Air (Prevention & Control of Pollution) Act, 1981.

2. Documents Relied Upon:
(a) The content of Lease deed agreement for the Plot No. 154/01, 163/pj Area - 15000 sq. Ft. For thirty years.
(b) The content of Agreement made with Adityapur Waste Management Pvt. Ltd. for disposal of Industrial Waste Water and Industrial hazardous wastes valid till 31.03.2021.
(c) The content of Self declaration to obtain raw material from local valid traders.
(d) The content of Discharge consent order vide 1233 dated 02.05.2008 valid up to 31.12.2008. Emission consent order vide 3181 dated 19.09.2006 valid up to 30.09.2007.
(e) The content of Impaction Report (I.R.), Ref. 1614 dated 18.09.2019 of Regional Officer, Regional Office-Cum-Laboratory, Jamshedpur.

3. The consent is granted under section 25 (2) of the Water (Prevention & Control of Pollution) Act, 1974 and under section 21 of the Air (Prevention & Control of Pollution) Act, 1981 in respect of the project ID: MAZRA-KRISHNANAPUR, P.S-ADITYAPUR, District-SERAIKELA-KHARSAWAN, as follows:

Project	Site/Area	Area (sq. Ft.)	Production Capacity	Period of CTO
Refer: Expansion	NS-3 Khata No. 181	4500 sq. Ft.	450/61 LAKTIS Auto component - 6000/MTV	31/03/2020

(A) Specific Conditions:
1. That, the occupier shall submit AAR, SMR, Emission and Noise monitoring report to the Board.

सूक्ष्म, लघु और मध्यम उद्यम संस्थान
MINISTRY OF MICRO, SMALL & MEDIUM ENTERPRISES

CERTIFICATE

ZED SILVER

under MSME Sustainable (ZED) Certification Scheme awarded to

M/S CORDOBA ENGINEERING PRIVATE LIMITED

ENTERPRISE NAME
Flat No- NS3, Building - 1st Phase, Road/Street - Adityapur, Village/Town - Adityapur Industrial Area, Block- Indr Area Adityapur, City - Jamshedpur, SERAIKELA-KHARSAWAN, JHARKHAND-832109

28 Manufacture of fabricated metal products, except machinery and equipment

UDYAM-JH-22-0000181
UDYAM REGISTRATION NUMBER
Quality Austria Central Asia Private Limited
ASSESSMENT AGENCY

Issued on: September 8, 2023
Certificate No: 190423 26592

UDYAM REGISTRATION CERTIFICATE

UDYAM REGISTRATION NUMBER: UDYAM-JH-22-0000181

NAME OF ENTERPRISE: M/S CORDOBA ENGINEERING PRIVATE LIMITED

S.No.	Classification Year	Enterprise Type	Classification Date
1	2022-21	Small	05/05/2022
2	2022-23	Small	25/06/2022
3	2021-22	Small	16/05/2021
4	2020-21	Small	25/08/2020

TYPE OF ENTERPRISE: SMALL

MAJOR ACTIVITY: MANUFACTURING

SOCIAL CATEGORY OF ENTREPRENEUR: GENERAL

NAME OF UNIT(S):

S.No.	Name of Unit(s)
1	M/S CORDOBA ENGINEERING PRIVATE LIMITED

OFFICIAL ADDRESS OF ENTERPRISE:

Plot/Block No.	NS3	Name of Premises/Building	1st Phase
Village/Town	Adityapur Industrial Area	Block	Indr Adityapur
Road/Street/Lane	Adityapur	City	Jamshedpur
State	JHARKHAND	District	SERAIKELA-KHARSAWAN
Pin	832109	Post	832109
Mobile	9334808061	Email:	cordoba.engg@rediffmail.com

DATE OF INCORPORATION / REGISTRATION OF ENTERPRISE: 05/06/1991

DATE OF COMMENCEMENT OF PRODUCTION/BUSINESS: 05/06/1991

NATIONAL INDUSTRY CLASSIFICATION CODE(S):

S.No.	NSIC High	NSIC 4 High	NSIC 8 High	Activity
1	28	2811	2812	Manufacture of fabricated metal products, except machinery and equipment

qualityaustria
Succeed with Quality

CERTIFICATE

Quality Austria - Trainings, Zertifizierungs und Begutachtungsgesellschaft awards this qualityaustria certificate to the following organisation:

Cordoba Engineering (P) Ltd.
NS3, 1st Phase, Adityapur Industrial Area, Adityapur, Jamshedpur 832109, Jharkhand, India

Manufacture of Sheet Metal, Fabricated, Machined, Phosphated, Painted & Powder Coated Components

Vienna, 10 Sep. 2021
Quality Austria - Trainings, Zertifizierungs und Begutachtungsgesellschaft
AT-1010 Vienna, Zeltnergasse 103

Signatures removed for security reasons

Kornel Schreiber General Manager | Ing. Michael Diagonits, MSc Specialist representative | Page 1 / 1

5th GST

Government of India
Ministry of Finance

CERTIFICATE OF APPRECIATION

The Central Board of Indirect Taxes and Customs conveys its appreciation to CORDOBA ENGINEERING PRIVATE LIMITED having GST registration number 20AABCC0348K125 for their prompt filing of returns and payment of Goods and Services Tax during the year ending 2021-22, thereby substantially contributing to building a strong and resilient nation.

Vivek Johri
1/7/2022
Chairman

qualityaustria
Succeed with Quality

CERTIFICATE

Quality Austria - Trainings, Zertifizierungs und Begutachtungsgesellschaft awards this qualityaustria certificate to the following organisation:

Cordoba Engineering (P) Ltd.
NS3, 1st Phase, Adityapur Industrial Area, Adityapur, Jamshedpur 832109, Jharkhand, India

Manufacture of Sheet Metal, Fabricated, Machined, Phosphated, Painted & Powder Coated Components

Vienna, 10 Sep. 2021
Quality Austria - Trainings, Zertifizierungs und Begutachtungsgesellschaft
AT-1010 Vienna, Zeltnergasse 103

Signatures removed for security reasons

Kornel Schreiber General Manager | Ing. Michael Diagonits, MSc Specialist representative | Page 1 / 1

Government of India
Ministry of Commerce and Industry

Importer-Exporter Code

This is to certify that CORDOBA ENGINEERING PVT LTD is issued an Importer-Exporter Code (IEC) 0287012024 with details as follows:

IEC	0287012024
व्यापक नाम (को) / PAN	AABCC0348K
व्यापक नाम / Firm Name	CORDBA ENGINEERING PRIVATE LIMITED
प्रकार की प्रकृति / Nature of Concern	Private Limited
व्यापक नाम / Name of the Occupier	01/08/2017
व्यापक नाम / Name of the Occupier	NS-3, PHASE 1, ADITYAPUR INDUSTRIAL AREA, ADITYAPUR, JAMSHEDPUR, SERAIKELA KHARSAWAN, JHARKHAND, 832109
व्यापक नाम / Name of the Occupier	SATISH KUMAR GARG

For more information, please visit: <http://digi.gov.in> or visit the QR Code.

File Modified: 11/09/2023
File Number: 1431/11/CPA/10/1000002215/1431

Ministry Of Corporate Affairs

Date: 14-02-2024 4:24:34pm

Company Information

S.No.	Company/LLP Name	CIN/LLPIN	Company/LLP Status
1	CORDOBA ENGINEERING PVT LTD	U27109NP1991FC051935	Active

Company Activities

- PICNIC
- GAMES / SPORTS
- GET –TOGETHERS
- SOCIAL GATHERING

Social Activities

- Organising Blood donation Camps.
 - Providing hygienic water facilities to people below poverty line during summers.
 - Organising free health camps
 - Distribution of cloths and blankets to the weaker section of the society.
- Afforestation

Environmental Policy

- Create awareness for the environment which plays an
- Integral role in day to day business activities.
- Undertake all reasonable and economical viable steps
- To minimize adverse effects upon the environment.
- Comply with the requirements of relevant environmental
- policies, regulations and codes of practices.



- ✓ Rain Water Harvesting
- ✓ Discharging polluted water after neutralization.
- ✓ Use of proper exhaust systems.
- ✓ We avoid uses of Hazardous Chemicals



Company Policy

- Protecting the health and safety of its employees and visitors.
- Not to use, possess, manufacture, distribute, dispense, transport, promote, or sell illegal or illicit drugs or drug paraphernalia while on Company business or on Company premises.
- Our hiring policies and practices require that there be no discrimination because of race, color, religion, age, gender, sexual orientation, gender identity or national origin.
- Social responsibility is an inescapable element of the long-term success of our company, just as it is for our stakeholders, business partners, employees and our customers.
- We respect and support compliance with internationally accepted human rights policies and laws.
- We condemn all forms of forced and compulsory labor.
- We support the effective abolition of exploitative child labor.
- We comply with national provisions and agreements regarding working hours and regular, paid holidays.
- We strictly adhere to all local and applicable local laws and regulations related to corruption and ethics, and require its suppliers to act in a similar manner.
- We will endeavor to protect the personal information of our employees, customers and anyone else we are engaged in business with, in accordance with each country's laws.
- We do not offer, give, solicit, or receive any form of bribe, kickback, or improper inducement in order to secure business from customers.
- Employees are responsible for the proper use and security of company property entrusted to you.
- Theft of Company assets is the most fundamental breach of the employment relationship.



Health, Safety & Environment Policy (HSE Policy)

- To Be Compliance With All Applicable Rules And Regulations Of The Country And States On Health, Safety And Environment Pertaining To Each Area Of Operation.
- To Carry Out All Operations And Activities In A Manner Of Safe Practices Avoiding Risk To The Employees, Neighbors And Environment.
- To Deliver Safe Products And Services Meeting Requirements Of The Customers Accepted Standards On Health, Safety And Environment.
- To Ensure That All Risks Are Identified, Eliminated Or Reduced As Low As Reasonably Practicable.
- To Incorporate Health, Safety And Environmental Issues Into The Planning, Monitoring And Review Of All Work Activities Undertaken.
- To Provide Relevant Information Of The HSE Policy To The Concerned Authorities Interested Parties, Suppliers, Contractors And Transporters.
- To Allocate Adequate Resources For The Effective Implementation Of Health, Safety And Environmental Management Systems.
- To Continually Review The HSE Policy For Adequacy, Suitability And Currency To Ensure Compliance With The Necessary Requirements.



CSR Activities



Contact Us

Registered Office

NS-3, 1st Phase, Adityapur Industrial Area, Jamshedpur, Jharkhand
- 832109, India

Gajanan Engineering - Sister Concern

Plot D-7 to D-10, 1st Phase Adityapur Ind. Area, Jamshedpur,
Jharkhand - 832109, India

Contact Person : Mr. G.S.S Verma
(M) +919334082878,

Email : info@cordobaengineering.com

Website: <http://www.cordobaengineering.com>



Thank
You!

